

NEW PERFORMANCE QUALITY

Biglia

B301, B501, B650, B658, B1200

B446 T2, B465 T2

B446 T3, B465 T3, B545, B565, B745, B765

B620

B750, B1250 (16 station turret)

BV210, BV315

Quattro B445, B470

Eurotech

B446 T2, B465 T2

B446 T3, B465 T3, B545, 735, 835

B620

B750, B1250 (16 station turret)

730SLY, 830SLY

E42SL

- High quality bearings
- 8000 RPM
- 80 bar
- 50 Nm



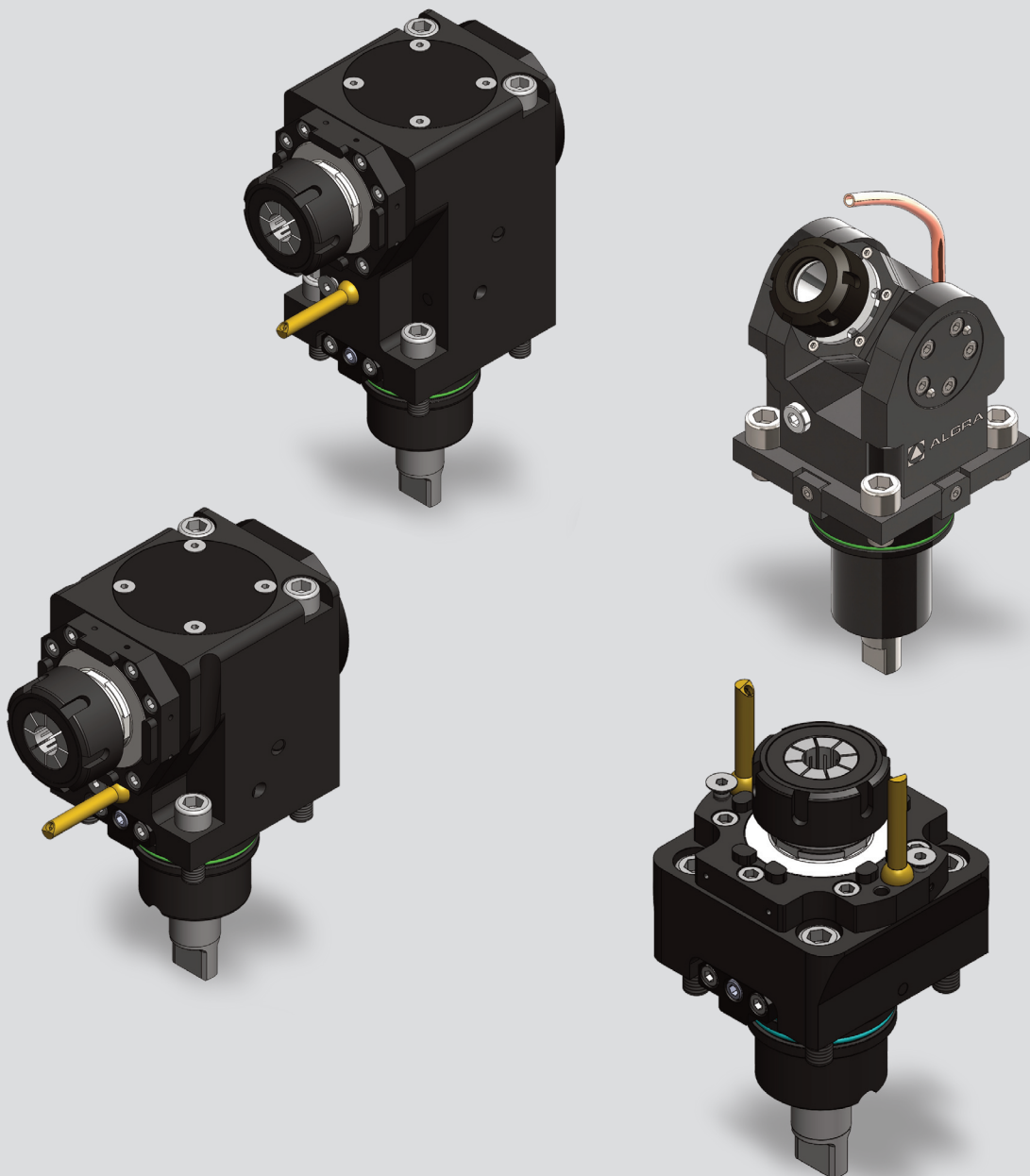

Toolholder Program

B55





Biglia
 B301, B501, B650, B658, B1200
 B446 T2, B465 T2
 B446 T3, B465 T3, B545, B565, B745, B765
 B620
 B750, B1250 (16 station turret)
 BV210, BV315
 Quattro B445, B470



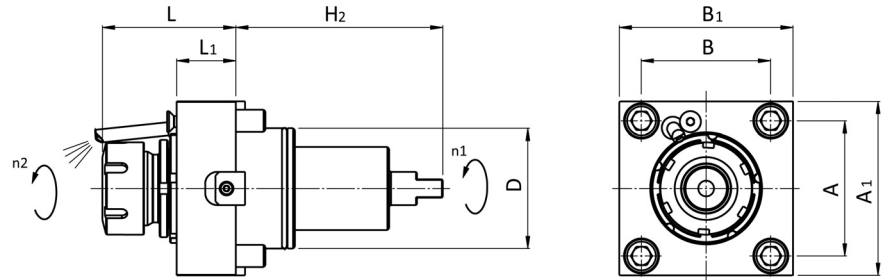
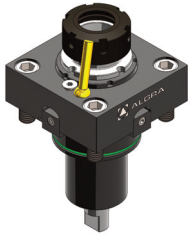

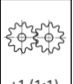
Eurotech
 B446 T2, B465 T2
 B446 T3, B465 T3, B545, 735, 835
 B620
 B750, B1250 (16 station turret)
 730SLY, 830SLY
 E42SL

B55	Version Clamping	Tools Height	Center speed	Max.	Ratio	External Coolant	Biglia code	Internal Coolant	Biglia code	Page
	0°	ER25 - DIN6499		8000rpm	i=1:1	RAPPS 25 121UB55	10.57.88.00	RAPPS 25 131UB55	10.57.88.00	3
		ER32 - DIN6499		8000rpm	i=1:1	RAPPS 32 121UB55	T134-00061 T134-00089	RAPPS 32 131UB55	T134-00071 T134-00089	3 3
		Ø16mm - DIN6358		8000rpm	i=1:1	RAPFM 16 121UB55	T134-00050			4
		Ø22mm - DIN6358		8000rpm	i=1:1	RAPFM 22 121UB55				4
	0° Double	ER20- DIN6499		6000rpm	i=1:1	RAPPTY20 121UB55/50		RAPPTY20 131UB55/50		5
	90°	ER25 - DIN6499	70mm	8000rpm	i=1:1	RRPPS 25 321UB55	10.57.87.00	RRPPS 25 331UN55		6
		ER32 - DIN6499	70mm	8000rpm	i=1:1	RRPPS 32 321UB55	T134-00062	RRPPS 32 331UN55		6
		ER25 - DIN6499	100mm	8000rpm	i=1:1	RRPPS 25 521UB55	T134-00076	RRPPS 25 531UB55		6
		ER32 - DIN6499	100mm	8000rpm	i=1:1	RRPPS 32 521UB55	T134-00077	RRPPS 32 531UB55	T134-00088	6
		ER16 - DIN6499	100mm	24000rpm	i=1:4	RRPPS 16 522UB55		RRPPS 16 532UB55	T134-00111	7
		Ø22mm - DIN6358	100mm	8000rpm	i=1:1	RRPFS 22 521UB55				8
	90° Double	ER25 - DIN6499	70mm	8000rpm	i=1:1	RRPPT 25 321UB55				8
ER32 - DIN6499	70mm	8000rpm	i=1:1	RRPPT 32 321UB55						
ER25 - DIN6499	100mm	8000rpm	i=1:1	RRPPT 25 521UB55						
ER32 - DIN6499	100mm	8000rpm	i=1:1	RRPPT 32 521UB55						
	±90°	ER16 - DIN6499		8000rpm	i=1:1	ROPPS 16 121UB55	T134-00025	ROPPS 16 131UB55		9
		ER20 - DIN6499		8000rpm	i=1:1	ROPPS 20 121UB55	T134-00057	ROPPS 20 131UB55		

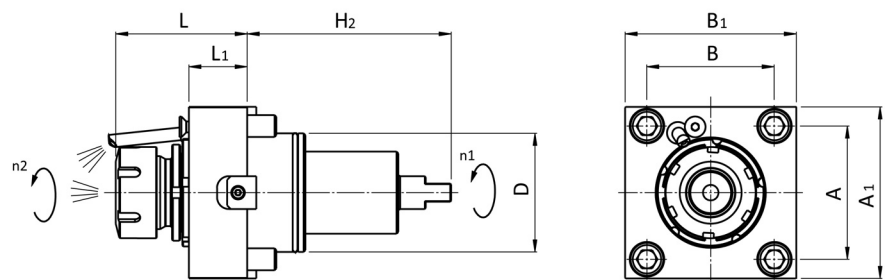
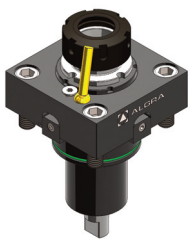

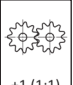

1/B55			Codice code - code - Bestell Nr.	D	ER	H	H1	H2	H3	L (min-max)	L1	L2	A	B	A1	B1	A2	B2	M ₂ Nm	n ₂ min-1	P kW
0°			RAPPS 25 121UB55	55	25			94		85,5	54		63	65	94	90			50	8000	
			RAPPS 32 121UB55	55	32			94		87	54			63	65	94	90			50	8000
																					



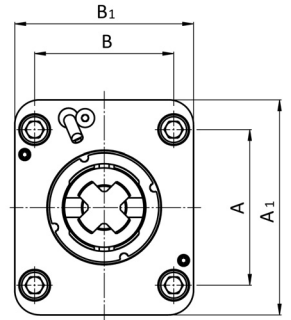
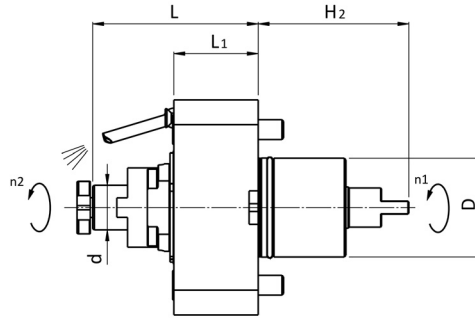

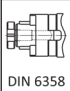
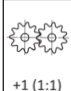
2/B55			Codice code - code - Bestell Nr.	D	ER	H	H1	H2	H3	L (min-max)	L1	L2	A	B	A1	B1	A2	B2	M ₂ Nm	n ₂ min-1	P kW
0°			RAPPS 25 131UB55	55	25			94		85,5	54		63	65	94	90			50	8000	
			RAPPS 32 131UB55	55	32			94		87	54			63	65	94	90			50	8000
																					
																					
																					



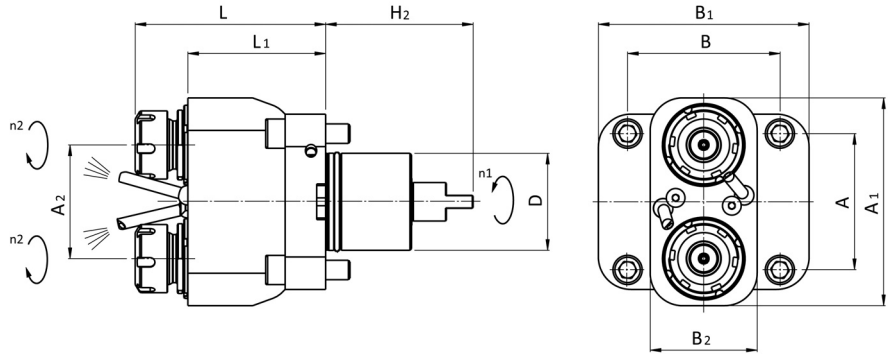

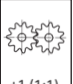

3/B55		Codice code - code - Bestell Nr.	D	ER	H	H1	H2	H3	L (min-max)	L1	L2	A	B	A1	B1	A2	B2	M ₂ Nm	n ₂ min-1	P kW
   +1 (1:1)	 EXTERNAL	RAPFM 16 121UB55	55	16			94		89	54		63	65	94	90			50	8000	
		RAPFM 22 121UB55	55	22				94		91	54		63	65	94	90			50	8000

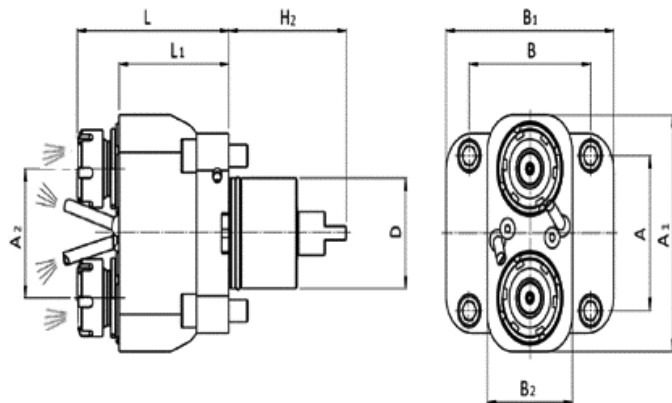

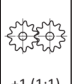



4/B55		Codice code - code - Bestell Nr.	D	ER	H	H1	H2	H3	L (min-max)	L1	L2	A	B	A1	B1	A2	B2	M ₂ Nm	n ₂ min-1	P kW
0°	 DIN 6499	 +1 (1:1)	RAPPTY 20 121UB55/50	55	20		94		78			63	65	100	90			20	6000	
 EXTERNAL																				

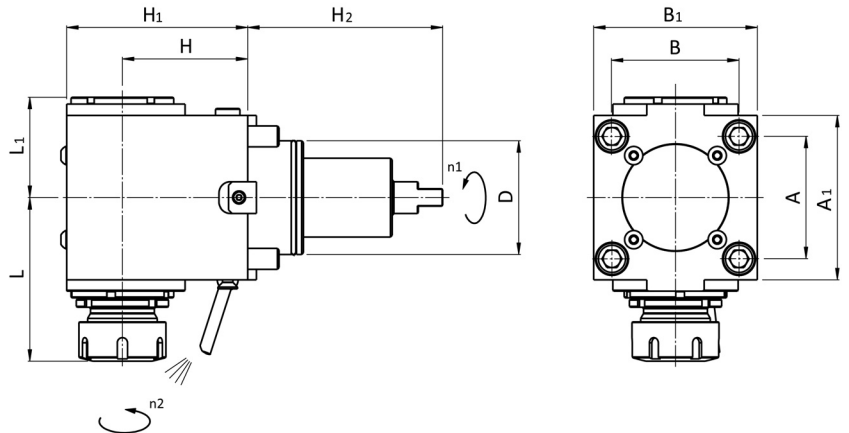



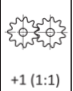

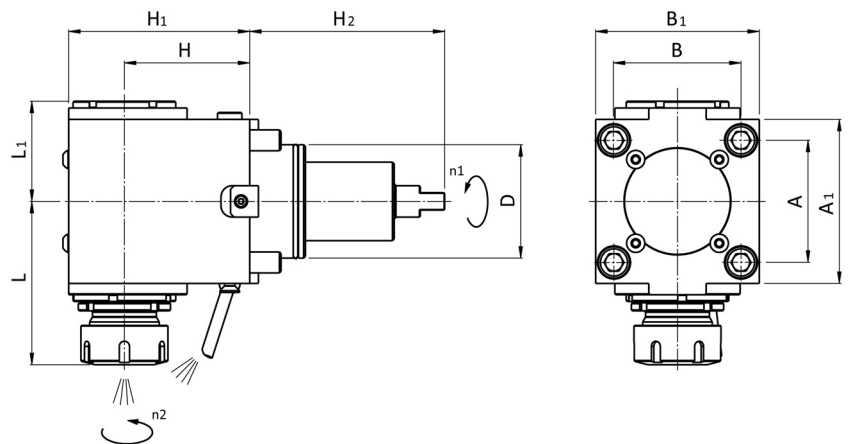

5/B55		Codice code - code - Bestell Nr.	D	ER	H	H1	H2	H3	L (min-max)	L1	L2	A	B	A1	B1	A2	B2	M ₂ Nm	n ₂ min-1	P kW
0°	 DIN 6499	 +1 (1:1)	RAPPTY 20 131UB55/50	55	20		94		78			63	65	100	90			20	6000	
 INT./EXT.	 80 bar	 Filtration 30µm																		

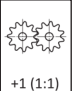

6/B55		Codice code - code - Bestell Nr.	D	ER	H	H1	H2	H3	L (min-max)	L1	L2	A	B	A1	B1	A2	B2	M ₂ Nm	n ₂ min-1	P kW
  		RRPPS 25 321UB55	55	25	70	135	94		88,5	53,5		63	65	84	90			50	8000	
		RRPPS 32 321UB55	55	32	45	135	94		90	53,5		63	65	84	90			50	8000	
		RRPPS 25 521UB55	55	25	100	135	94		88,5	53,5		63	65	84	90			50	8000	
		RRPPS 32 521UB55	55	32	100	135	94		90	53,5		63	65	84	90			50	8000	



7/B55		Codice code - code - Bestell Nr.	D	ER	H	H1	H2	H3	L (min-max)	L1	L2	A	B	A1	B1	A2	B2	M ₂ Nm	n ₂ min-1	P kW
  	  	RRPPS 25 331UB55	55	25	70	135	94		88,5	58		63	65	84	90			50	8000	
		RRPPS 32 331UB55	55	32	45	135	94		90	58		63	65	84	90			50	8000	
		RRPPS 25 531UB55	55	25	100	135	94		88,5	58		63	65	84	90			50	8000	
		RRPPS 32 531UB55	55	32	100	135	94		90	58		63	65	84	90			50	8000	

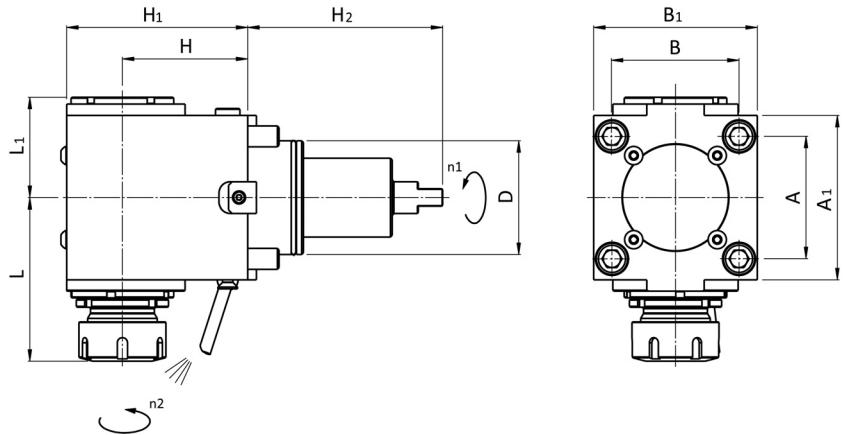
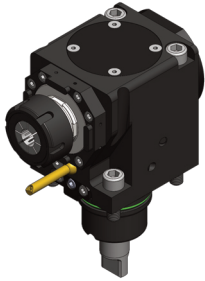

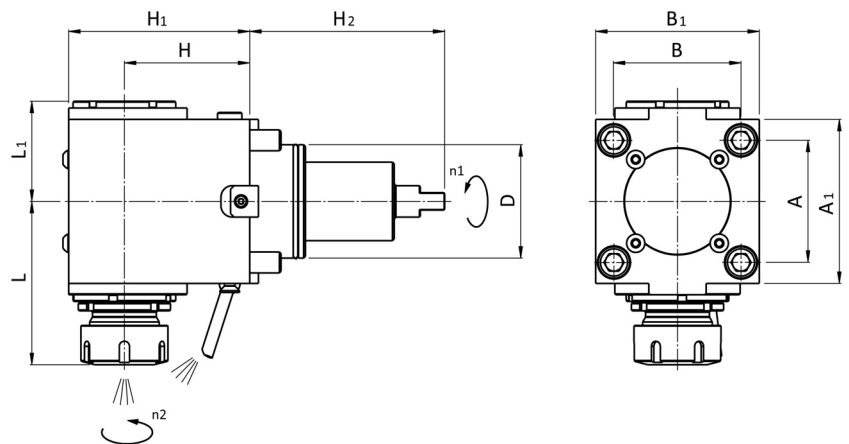

8/B55		Codice code - code - Bestell Nr.	D	ER	H	H1	H2	H3	L (min-max)	L1	L2	A	B	A1	B1	A2	B2	M ₂ Nm	n ₂ min-1	P kW
90°		RRPPS 16 522UB55	55	16	100	135	94		79	45		63	65	84	90			4	24000	



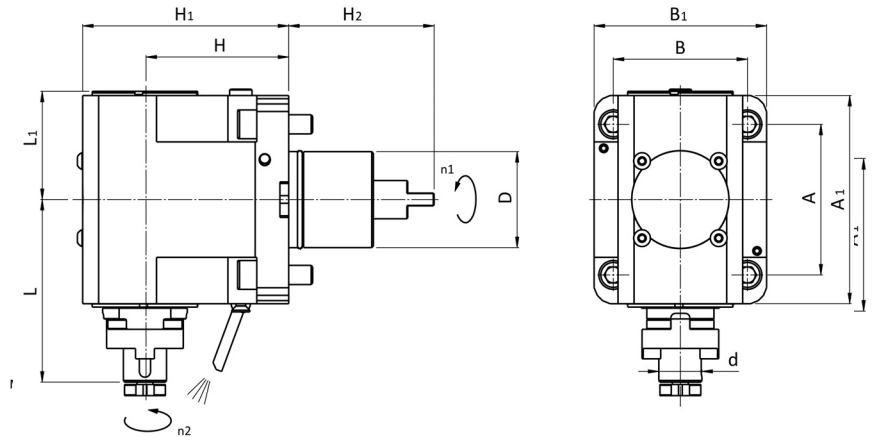

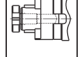

9/B55		Codice code - code - Bestell Nr.	D	ER	H	H1	H2	H3	L (min-max)	L1	L2	A	B	A1	B1	A2	B2	M ₂ Nm	n ₂ min-1	P kW
90°		RRPPS 16 532UB55	55	16	100	135	94		79	45		63	65	84	90			4	24000	

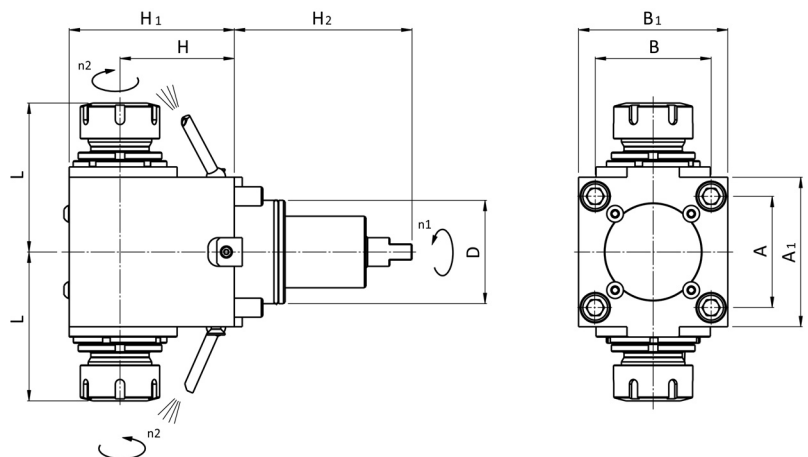
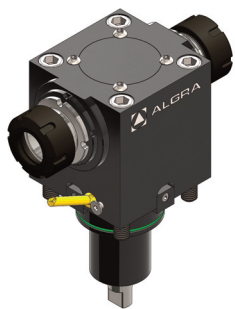



10/B55			Codice	D	ER	H	H1	H2	H3	L	L1	L2	A	B	A1	B1	A2	B2	M ₂	n ₂	P	
			code - code - Bestell Nr.							(min-max)									Nm	min-1	kW	
   DIN 6358 ±1 (1:1)			RRPFS 22 521UB55	55	22	100	137	94		91,5	53,5		63	65	84	90				50	8000	
 EXTERNAL																						



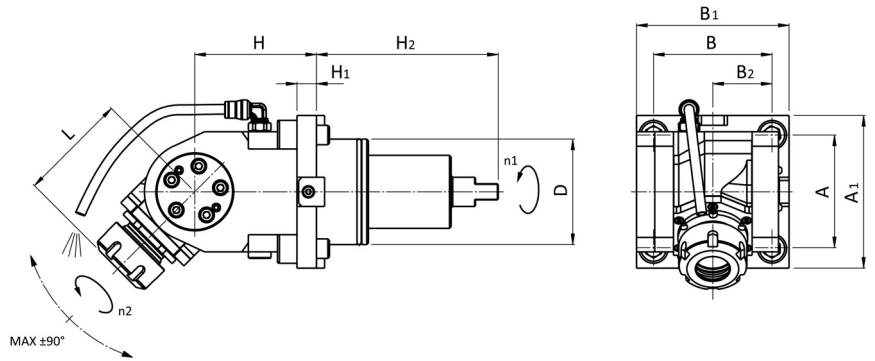

11/B55			Codice	D	ER	H	H1	H2	H3	L	L1	L2	A	B	A1	B1	A2	B2	M ₂	n ₂	P
			code - code - Bestell Nr.							(min-max)									Nm	min-1	kW
   DIN 6499 ±1 (1:1)			RRPPT 25 321UB55	55	25	70	135	94		77,5	77,5		63	65	90	84			50	8000	
			RRPPT 32 321UB55	55	32	45	135	94		79	79		63	65	90	84			50	8000	
			RRPPT 25 521UB55	55	25	100	135	94		77,5	77,5		63	65	90	84			50	8000	
 EXTERNAL			RRPPT 32 521UB55	55	32	100	135	94		79	79		63	65	90	84			50	8000	

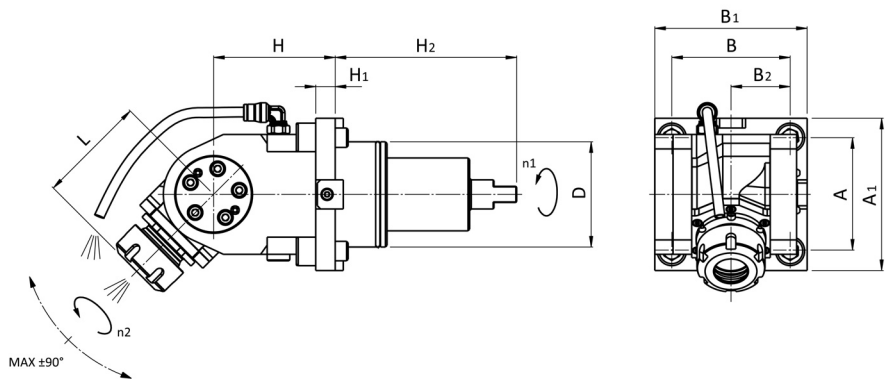

12/B55		Codice code - code - Bestell Nr.	D	ER	H	H1	H2	H3	L (min-max)	L1	L2	A	B	A1	B1	A2	B2	M ₂ Nm	n ₂ min-1	P kW
±90°			ROPPS 16 121UB55	55	16	55	30	94	57,5			63	63	81	90		45	15	8000	
			ROPPS 20 121UB55	55	20	55	30	94	59				63	63	81	90		45	15	8000



13/B55		Codice code - code - Bestell Nr.	D	ER	H	H1	H2	H3	L (min-max)	L1	L2	A	B	A1	B1	A2	B2	M ₂ Nm	n ₂ min-1	P kW
±90°			ROPPS 16 131UB55	55	16	55	30	94	57,5			63	63	81	90		45	15	8000	
			ROPPS 20 131UB55	55	20	55	30	94	59				63	63	81	90		45	15	8000



**La produzione:
il lavoro**Production:
work

La produzione viene sviluppata nella moderna struttura a temperatura controllata di Almenno San Salvatore, mentre negli stabilimenti di Brembilla (I-Bergamo) vengono effettuate le lavorazioni di montaggio ed assemblaggio di gruppi completi. La superficie coperta delle strutture è di mq. 15.000, dei quali mq. 1.000 sono adibiti agli uffici amministrativi, commerciali e tecnici. L'attività produttiva si svolge con l'utilizzo di impianti e macchinari CNC costantemente aggiornati alle nuove tecnologie ed in grado di sviluppare le seguenti lavorazioni:

- Asportazione di truciolo
- Elettroerosione
- Tornitura orizzontale e verticale
- Fresatura universale 5 assi
- Fresatura/tornitura
- Lappatura per fori e piani
- Rettifica in tondo interno ed esterno
- Rettifica in tangenziale oltre al montaggio di gruppi e sottogruppi completi.

The production is developed in the modern, temperature controlled facility in Almenno San Salvatore, with Brembilla factories there are the assembly operations and the assembly of complete groups. The facilities covered area is of 15,000 sqm., 1,000 sqm. of which are used for the administrative commercial and technical offices. The production cycle takes place with the use of CNC fixtures and equipment constantly updated with new technologies and able to develop the following machining:

- *Chip machining*
- *Electroerosion*
- *Horizontal and vertical turning*
- *5-axis universal milling*
- *Milling/turning*
- *Lapping for holes and plane surfaces*
- *Cylindrical internal and external grinding*
- *Tangential grinding in addition to the assembly of complete groups and subassemblies.*

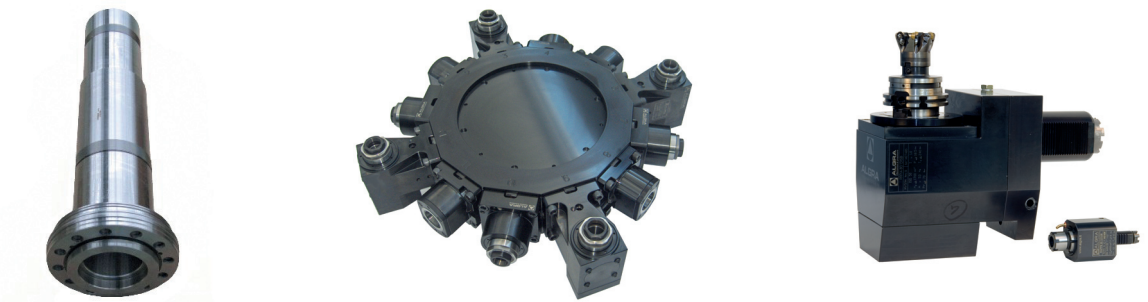
**Certificazioni:
uno standard
qualitativo**Certification:
a quality
standard

La tecnologia avanzata svolge un ruolo chiave nell'obiettivo di incrementare il proprio valore, quello dei propri prodotti, dei servizi e della capacità del personale, operando nel rispetto delle norme UNI EN ISO 9001:2008 e ISO 14001:2004. L'alto livello di sensibilità verso il rispetto delle regole di sicurezza e dell'ambiente è presente ed immediatamente percepito in tutte le strutture aziendali.

Advanced technology plays a key role aiming to increase its value and the products, services and staff capacity value, operating in compliance with UNI EN ISO 9001:2008 and ISO 14001:2004.

The high level of sensitivity towards the observance of safety rules and the environment is present and perceived immediately in all facilities.



UNI EN ISO 9001:2008 - Cert. n° 0141



UNI EN ISO 14001:2004 - Cert. n° 0270A

Our partners:

AUSTRALIA

MODERN TOOLS (VIC.) PTY LTD
2/2 Newcastle Rd
Bayswater, Australia, VIC 3153
Phone: +61 03 9761 2929

BENELUX

BUCCI INDUSTRIES BENELUX
Alée Verte 12, B-5150 Floreffe (Belgium)
Phone: +32 496 10 10 90

BRASIL

BUCCI INDUSTRIES BRASIL
R. Dr. Augusto De Miranda, 910
Vila Pompeia, São Paulo,
Brasile, SP, 05026-000
Phone: +55 19 3515 7220

BULGARIA

RAIS LTD
Пловдив, Бул. Освобождение 3, Ет. 3,
Plovdiv, Bulgaria, 4019
Phone: +359 34444255

CHINA

**SHANGHAI LUOTUO
AUTOMATION TECHNOLOGY CO**
NORTH GUYANG ROAD,
SONGJIANG DISTRICT
SHANGHAI, Cina, 201620
Phone: +86 2164120150

CZECH REPUBLIC

MACH TRADE S.R.O.
Podnikatelská 565, Běchovice,
190 11 Praha 9 (Czech Republic)
Phone: +420 603293270

FRANCE

BUCCI INDUSTRIES FRANCE SARL
145 Rue Louis Armand
Cluses, Francia, 74300
Phone: +32 81450282

GERMANY

BUCCI INDUSTRIES DEUTSCHLAND
Stammheimer Str, 10
D-70806 Kornwestheim - Germany
Phone: +49 7154 8370 700

INDIA

DWIJ CONSULTANTS
25, Payal Park Part-1, Satellite Road
Gujarat , India, 380015
Phone: +91 7926760747

JAPAN

BUCCI INDUSTRIES JAPAN-IGM NIPPON
Kamoi, 6-10-1 Midori-Ku, 226-0003
Yokohama-Shi Kanagawa
Phone: +81 45 931 5096

NEW ZELAND

SCOTT MACHINERY LIMITED
51 Gilberthorpes Rd, Hei Hei
Christchurch, Nuova Zelanda, 8441
Phone: +64 3-349 2266

POLAND

Narzędzia Skrawające TOOLS Sp. z o.o.
Ul. Władysława Grabskiego 25,
Siechnice, Polonia, 55-011
Phone: +48 713435858

RUSSIA

SOLVER ENGINEERING LLC
43 STANKEVICHIA STR
VORONEZH, Russia, 394006
Phone: +7 4732777222

SPAIN

DAISA TECHNOLOGIC, S.L.
Urdaneta Bidea, 13
Zarautz, Gipuzkoa, Spagna, 20800
Phone: +34 943133739

SWITZERLAND

BUCCI INDUSTRIES NORDIC
Route Du Granval 3
Belprahon, Svizzera, 2744
Phone: +41 324934054

TAIWAN

MONGTEC PRECISION INC
No.156, FUTAIN 3RD ST
TAICHUNG CITY, Taiwan, 40241
Phone: +886 422653360

TURKEY

**SELEN MAKINE VE TEKNOLOJİ
HİZ.SAN.TIC.LTD.STİ**
İbrahim Ağa Cd. No:255
Gebze/Kocaeli, Turchia, 41400
Phone: +90 2626413208

UNITED KINGDOM

YMT LTD
Tuscan House George Smith Way
Lufton, Yeovil , Regno Unito, BA22 8QR
Phone: +44 1935 428375

UNITED STATES

BUCCI INDUSTRIES USA, INC.
9332 Forsyth Park Dr
Charlotte, Stati Uniti, NC 28273
Phone: +1 7045838341



ALGRA S.p.A. Divisione accessori
Via Manzoni, 41 24031 Almenno S. Salvatore (BG)
Tel. +39 035.64.20.51 • Fax +39 035.64.01.28
algra.accessori@algra.it - www.algra.it