

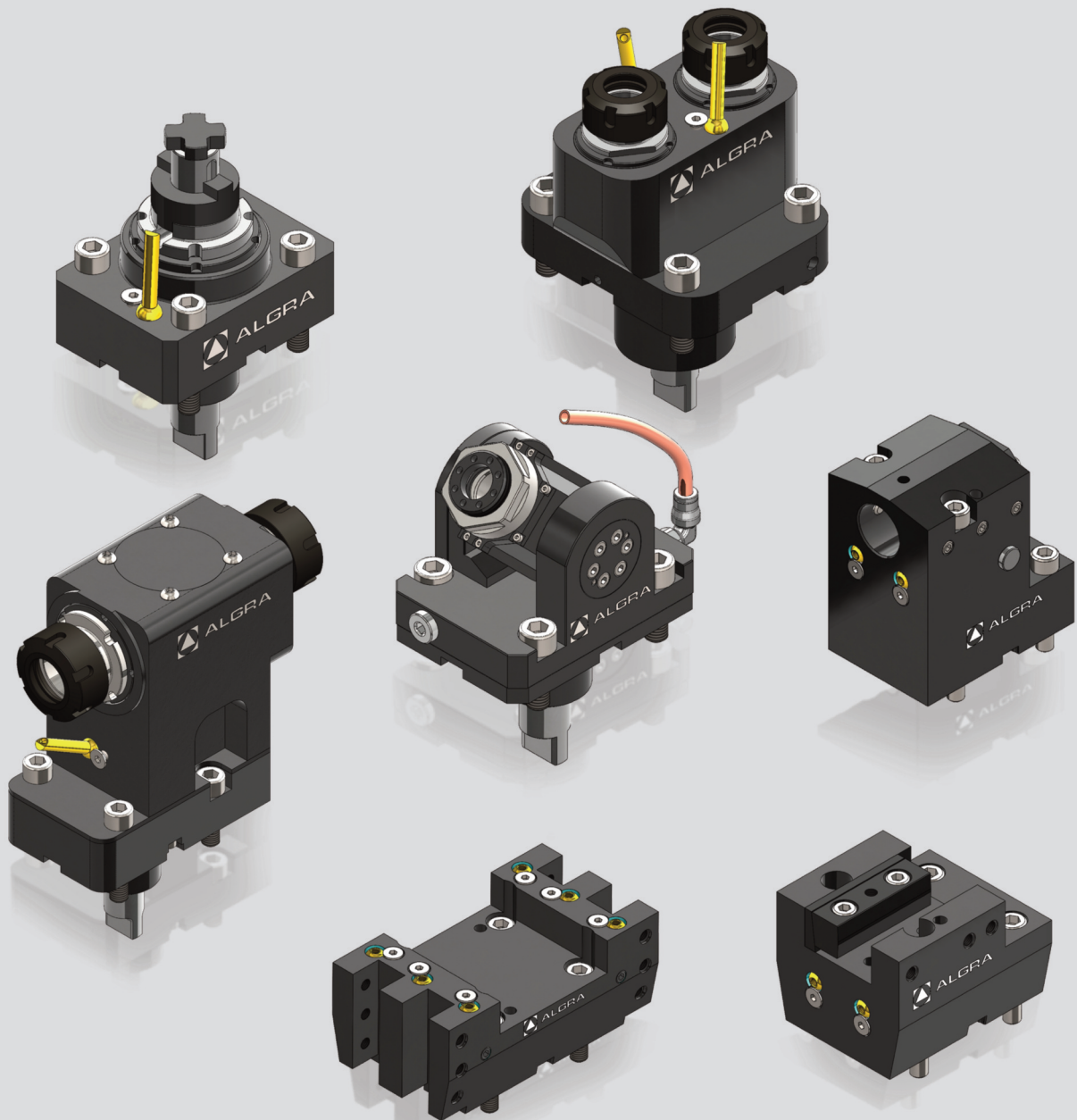





- DuraTurn 2050 MC
- DuraTurn 2550 MC
- NL / NLX 1500 - 20 station
- NL / NLX 2000 - 20 station
- NL / NLX 2500 - 20 station
- NT / NTX 1000
- NT / NTX 2000
- NT 3000 / 3100 / 3150 / 3200
- NZ / NZX 1500
- NZ / NZX 2000
- NZ / NZX 2500 - 16 station

Toolholder Program









# NZ







DuraTurn 2050 MC  
 DuraTurn 2550 MC  
 NL / NLX 1500 - 20 station  
 NL / NLX 2000 - 20 station  
 NL / NLX 2500 - 20 station  
 NT / NTX 1000  
 NT / NTX 2000  
 NT 3000 / 3100 / 3150 / 3200  
 NZ / NZX 1500  
 NZ / NZX 2000  
 NZ / NZX 2500 - 16 station

NZ	Version	Tools Clamping	Center Height	Max. speed	Ratio	External	Internal	Page
	0°	ER25 - DIN6499		12000rpm	i=1:1	RAPPS 25 121UNZ	RAPPS 25 131UNZ	4
		ER32 - DIN6499		12000rpm	i=1:1	RAPPS 32 121UNZ	RAPPS 32 131UNZ	4
		Ø22mm - DIN6358		12000rpm	i=1:1	RAPFS 22 121UNZ		5
		Ø16mm - DIN1835		12000rpm	i=1:1	RAPWS 16 121UNZ		5
	0° Double	ER20 - DIN6499		6000rpm	i=1:1	RAPPTY20 121UNZ	RAPPTY20 131UNZ	6
	90°	ER25 - DIN6499	85mm	12000rpm	i=1:1	RRPPS 25 121UNZ	RRPPS 25 131UNZ	7
		ER32 - DIN6499	85mm	12000rpm	i=1:1	RRPPS 32 121UNZ	RRPPS 32 131UNZ	7
		ER25 - DIN6499	125mm	12000rpm	i=1:1	RRPPA 25 421UNZ	RRPPA 25 431UNZ	8
		ER32 - DIN6499	125mm	12000rpm	i=1:1	RRPPA 32 421UNZ	RRPPA 32 431UNZ	8
		Ø22mm - DIN6358	85mm	12000rpm	i=1:1	RRPFS 22 121UNZ		9
		Ø16mm - DIN1835	85mm	12000rpm	i=1:1	RRPWS 16 121UNZ		9
	90° Double	ER25 - DIN6499	85mm	12000rpm	i=1:1	RRPPT 25 121UNZ		10
		ER32 - DIN6499	85mm	12000rpm	i=1:1	RRPPT 32 121UNZ		10
		ER25 - DIN6499	125mm	12000rpm	i=1:1	RRPPTA25 421UNZ		10
		ER32 - DIN6499	125mm	12000rpm	i=1:1	RRPPTA32 421UNZ		10
	±90°	ER20 - DIN6499		12000rpm	i=1:1	ROPPS 20 121UNZ	ROPPS 20 131UNZ	11

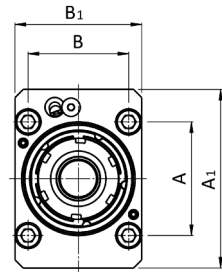
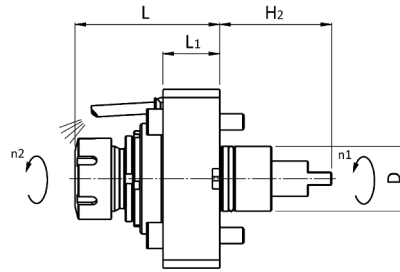
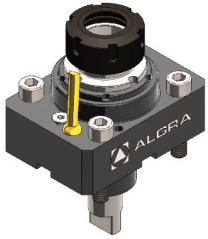
DuraTurn 2050 MC
DuraTurn 2550 MC
NL / NLX 1500 - 20 station
NL / NLX 2000 - 20 station
NL / NLX 2500 - 20 station
NT / NTX 1000
NT / NTX 2000
NT 3000 / 3100 / 3150 / 3200
NZ / NZX 1500
NZ / NZX 2000
NZ / NZX 2500 - 16 station





NZ	Version	Tools Clamping	Center Height	Coolant	ALGRA Part No.	DMG MORI Part No.	Page
	O.D. cutting holder	□ 20mm	H:70mm	External	E10/US 20 NZX70	T00224	12
		□ 25mm	H:70mm	External	E10/US 25 NZX70	T00267	12
		□ 0.75"	H:70mm	External	E10/US 0.75" NZX70	T00234	12
		□ 20mm	H:95mm	External	E10/US 20 NZX95	T00225	12
		□ 25mm	H:95mm	External	E10/US 25 NZX95		12
		□ 0.75"	H:95mm	External	E10/US 0.75" NZX95	T00235	12
		□ 1"	H:70mm	External	E10/US 1" NZX70	T00272	12
	O.D. double holder	□ 20mm	H:70mm	External	E10/UD 20 NZX70	T00228	12
		□ 25mm	H:70mm	External	E10/UD 25 NZX70		12
		□ 0.75"	H:70mm	External	E10/UD 0.75" NZX70	T00250	12
		□ 20mm	H:95mm	External	E10/UD 20 NZX95	T00226	12
		□ 25mm	H:95mm	External	E10/UD 25 NZX95		12
		□ 0.75"	H:95mm	External	E10/UD 0.75" NZX95	T00249	12
	O.D. Y-axis double toolholders for both spindle	□ 20 mm	H70:mm	External	E10/UQ 20 NZX70		13
	Face and I.D. cutting holder	□ 20mm	H:80mm	External	E10/UA 20 NZX80	T03017	13
		□ 25mm	H:80mm	External	E10/UA 25 NZX80	T03024	13
		□ 0.75"	H:80mm	External	E10/UA 0.75" NZX80	T03018	13
		□ 1"	H:80mm	External	E10/UA 1" NZX80	T03025	13
	Cut-off holder	□ 20mm	H:85mm	External	E10/UT 20 NZX85	T00251	14
		□ 25mm	H:70mm	External	E10/UT 25 NZX70		14
		□ 25mm	H:85mm	External	E10/UT 25 NZX85	T00268	14
		□ 0.75"	H:85mm	External	E10/UT 0.75" NZX85	T00252	14
		□ 1"	H:85mm	External	E10/UT 1" NZX85	T00359	14
	Blade Holder	⌀ 32mm	H:70mm	External	E10/TT 32 NZX70		14
	Boring Bar holder	⌀ 32mm	H:100mm	Int/Ext	E10/BS 32 NZX100	T10115 - T13132	15
		⌀ 1.25"	H:100mm	Int/Ext	E10/BS 1.25" NZX100	T10119 - T13135	15
		⌀ 32mm	H:145mm	Int/Ext	E10/BS 32 NZX145	T10260	15
		⌀ 1.25"	H:145mm	Int/Ext	E10/BS 1.25" NZX145	T10261	15
	Boring Bar holder	⌀ 25mm	H:75mm/105mm	Int/Ext	E10/BD 25 NZX75/105	T10117	15
		⌀ 1"	H:75mm/105mm	Int/Ext	E10/BD 1" NZX75/105	T10139	15



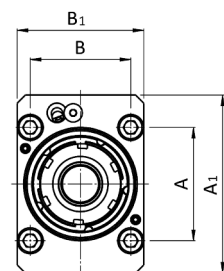
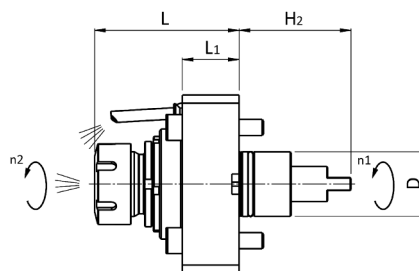

1/NZ			Codice code - code - Bestell Nr.	D	ER	H	H1	H2	L (min-max)	L1	L2	A	B	A1	B1	A2	B2	M <sub>2</sub> Nm	n <sub>2</sub> min-1	P kW
0°			RAPPS 25 121UNZ	40	25			69	80,6-84,3	35		70	62	110	78			50	12000	7,5
	DIN 6499	+1 (1:1)	RAPPS 32 121UNZ	40	32			69	85,5-89,2	35		70	62	110	78			50	12000	7,5
	EXTERNAL																			

4



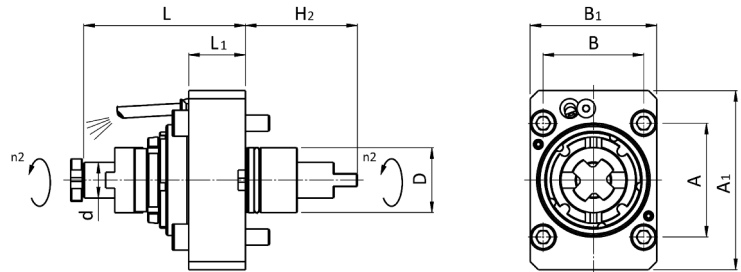
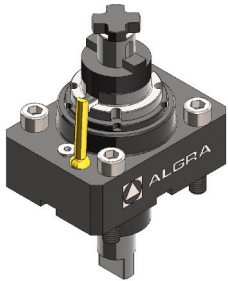

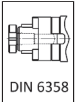
2/NZ			Codice code - code - Bestell Nr.	D	ER	H	H1	H2	L (min-max)	L1	L2	A	B	A1	B1	A2	B2	M <sub>2</sub> Nm	n <sub>2</sub> min-1	P kW
0°			RAPPS 25 131UNZ	40	25			69	80,6-84,3	35		70	62	110	78			50	12000	7,5
	DIN 6499	+1 (1:1)	RAPPS 32 131UNZ	40	32			69	85,5-89,2	35		70	62	110	78			50	12000	7,5
			INT./EXT. 100 bar Filtration 30µm																	



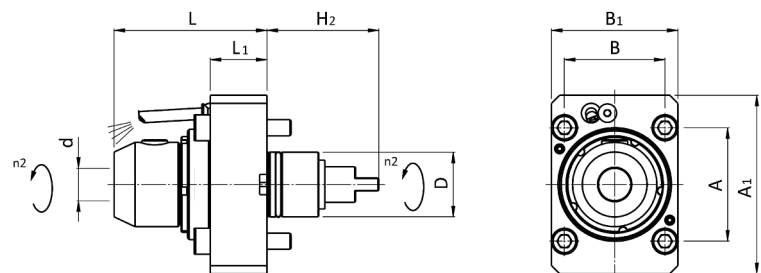

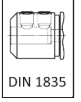
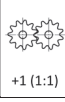
3/NZ			Codice	D	d	H	H1	H2	L	L1	L2	A	B	A1	B1	A2	B2	M <sub>2</sub>	n <sub>2</sub>	P	
			code - code - Bestell Nr.															Nm	min-1	kW	
0°			RAPFS 22 121UNZ	40	∅22			69	100	35		70	62	110	78			50	12000	7,5	
  +1 (1:1)																					
 EXTERNAL																					



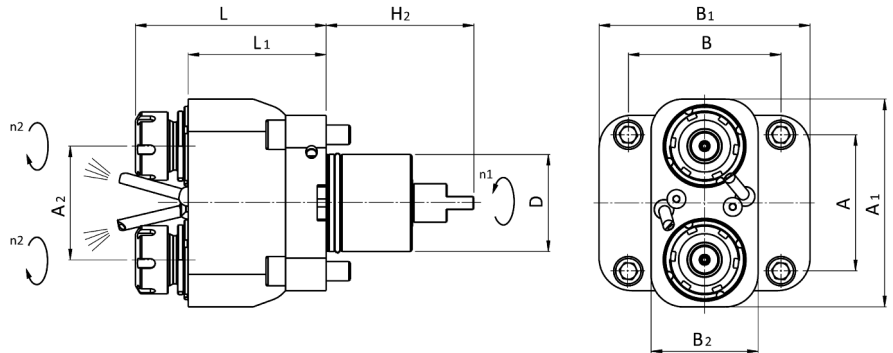



4/NZ			Codice	D	d	H	H1	H2	L	L1	L2	A	B	A1	B1	A2	B2	M <sub>2</sub>	n <sub>2</sub>	P	
			code - code - Bestell Nr.															Nm	min-1	kW	
0°			RAPWS 16 121UNZ	40	∅16			69	90	35		70	62	110	78			50	12000	7,5	
  +1 (1:1)																					
 EXTERNAL																					

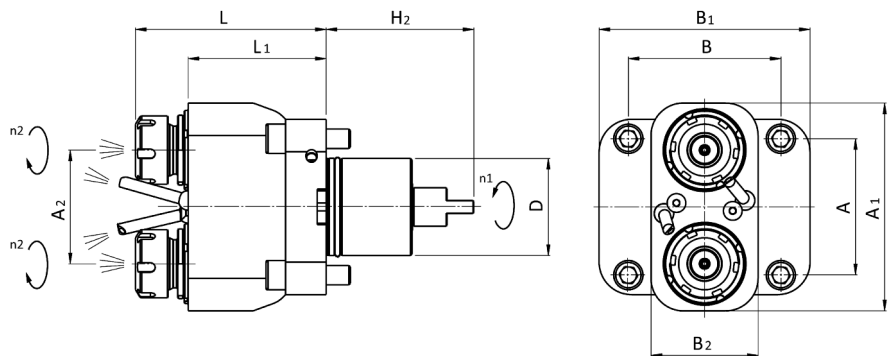

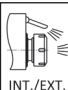

5/NZ			Codice	D	ER	H	H1	H2	L	L1	L2	A	B	A1	B1	A2	B2	M <sub>2</sub>	n <sub>2</sub>	P
			code - code - Bestell Nr.						(min-max)									Nm	min-1	kW
0°			RAPPTY20 121UNZ	40	20			69	87,8-91,5	70		62	70	105	95	60	61,5	30	6000	5,5
 EXTERNAL																				



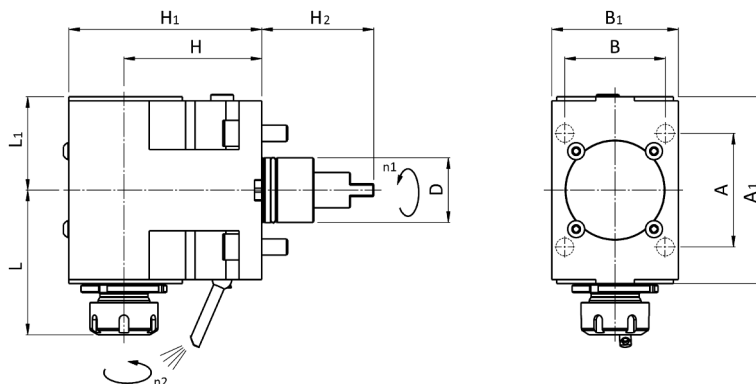



6/NZ			Codice	D	ER	H	H1	H2	L	L1	L2	A	B	A1	B1	A2	B2	M <sub>2</sub>	n <sub>2</sub>	P
			code - code - Bestell Nr.						(min-max)									Nm	min-1	kW
0°			RAPPTY20 131UNZ	40	20			69	87,8-91,5	70		62	70	105	95	60	61,5	30	6000	5,5
 INT./EXT.																				
 100 bar																				
 Filtration 30µm																				

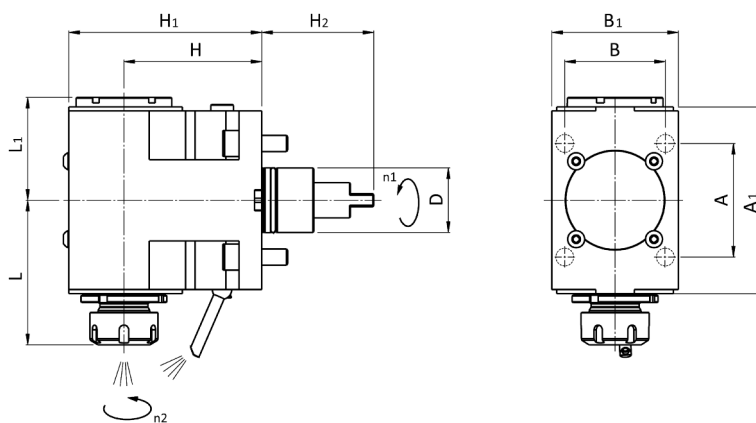

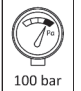

7/NZ			Codice	D	ER	H	H1	H2	L	L1	L2	A	B	A1	B1	A2	B2	M <sub>2</sub>	n <sub>2</sub>	P
			code - code - Bestell Nr.						(min-max)									Nm	min-1	kW
90°			RRPPS 25 121UNZ	40	25	85	119	69	85,3-89	57,5		70	62	110	78			50	12000	7,5
			RRPPS 32 121UNZ	40	32	85	119	69	90,3-94	57,5		70	62	110	78				50	12000
																				



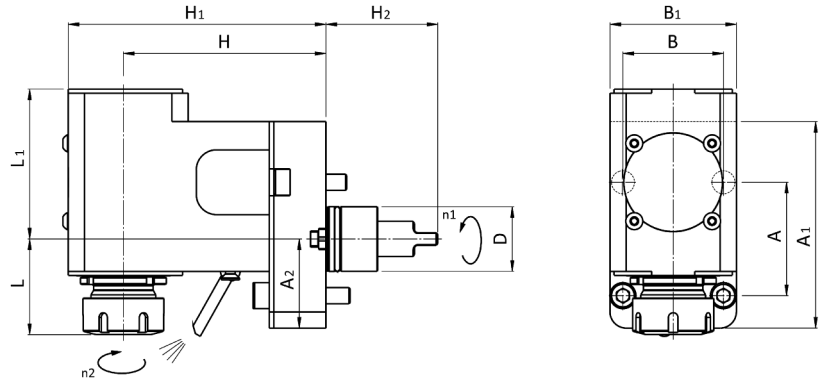

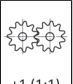

8/NZ			Codice	D	ER	H	H1	H2	L	L1	L2	A	B	A1	B1	A2	B2	M <sub>2</sub>	n <sub>2</sub>	P
			code - code - Bestell Nr.						(min-max)									Nm	min-1	kW
90°			RRPPS 25 131UNZ	40	25	85	119	69	85,3-89	63,4		70	62	110	78			50	12000	7,5
			RRPPS 32 131UNZ	40	32	85	119	69	90,3-94	63,4		70	62	110	78				50	12000
																				
																				
																				

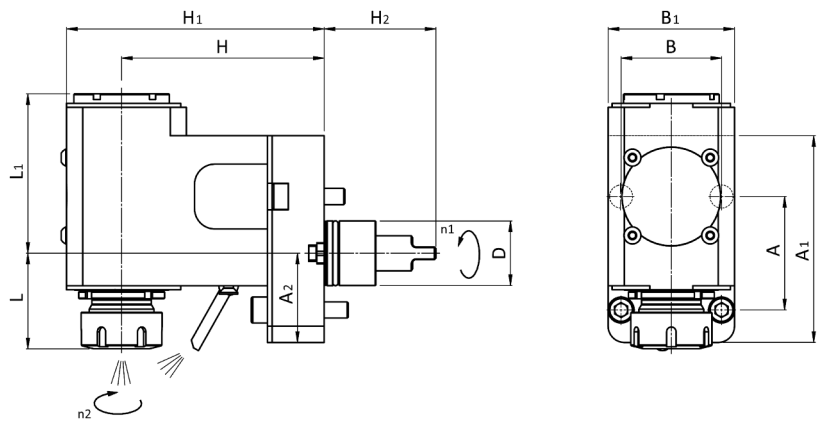



9/NZ		Codice code - code - Bestell Nr.	D	ER	H	H1	H2	L (min-max)	L1	L2	A	B	A1	B1	A2	B2	M <sub>2</sub> Nm	n <sub>2</sub> min-1	P kW
90°	 DIN 6499	 +1 (1:1)	RRPPA 25 421UNZ	40	25	125	69	159	50,4÷54,1	92,5		70	62	127,5	78	55	50	12000	7,5
			RRPPA 32 421UNZ	40	32	125	69	159	55,3÷59	92,5		70	62	127,5	78	55	50	12000	7,5
 EXTERNAL																			



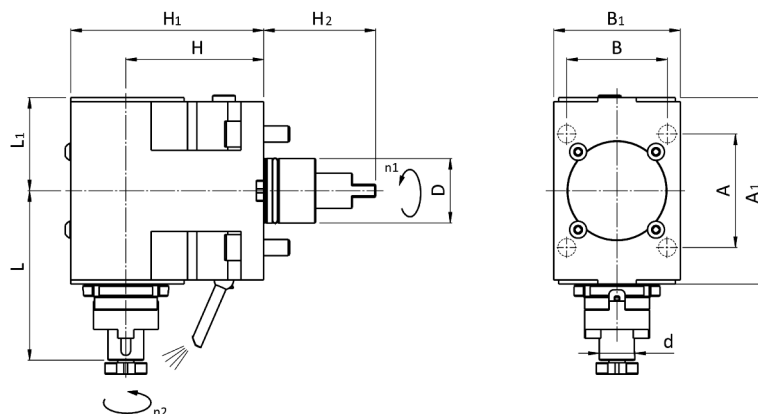

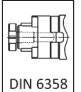
10/NZ		Codice code - code - Bestell Nr.	D	ER	H	H1	H2	L (min-max)	L1	L2	A	B	A1	B1	A2	B2	M <sub>2</sub> Nm	n <sub>2</sub> min-1	P kW
90°	 DIN 6499	 +1 (1:1)	RRPPA 25 431UNZ	40	25	125	69	159	50,4÷54,1	98,4		70	62	127,5	78	55	50	12000	7,5
			RRPPA 32 431UNZ	40	32	125	69	159	55,3÷59	98,4		70	62	127,5	78	55	50	12000	7,5
 INT./EXT.	 100 bar	 Filtration 30µm																	



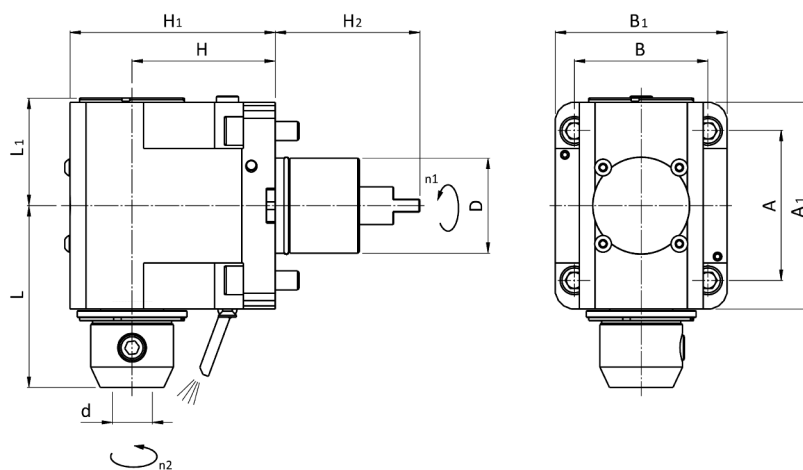

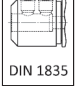
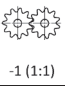
11/NZ			Codice	D	d	H	H1	H2	L	L1	L2	A	B	A1	B1	A2	B2	M <sub>2</sub>	n <sub>2</sub>	P
			code - code - Bestell Nr.															Nm	min <sup>-1</sup>	kW
  			RRPFS 22 121UNZ	40	∅ 22	85	119	69	104,6	57,5		70	62	110	78			50	12000	7,5
																				



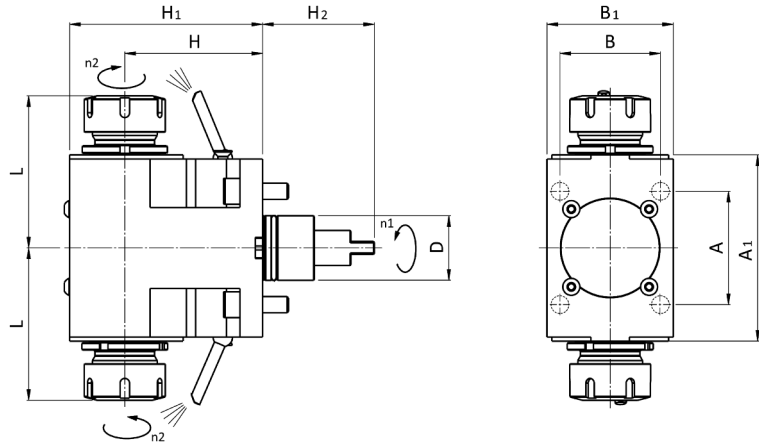

12/NZ			Codice	D	d	H	H1	H2	L	L1	L2	A	B	A1	B1	A2	B2	M <sub>2</sub>	n <sub>2</sub>	P
			code - code - Bestell Nr.															Nm	min <sup>-1</sup>	kW
  			RRPWS 16 121UNZ	40	∅ 16	85	119	69	98	57,5		70	62	110	78			50	12000	7,5
																				



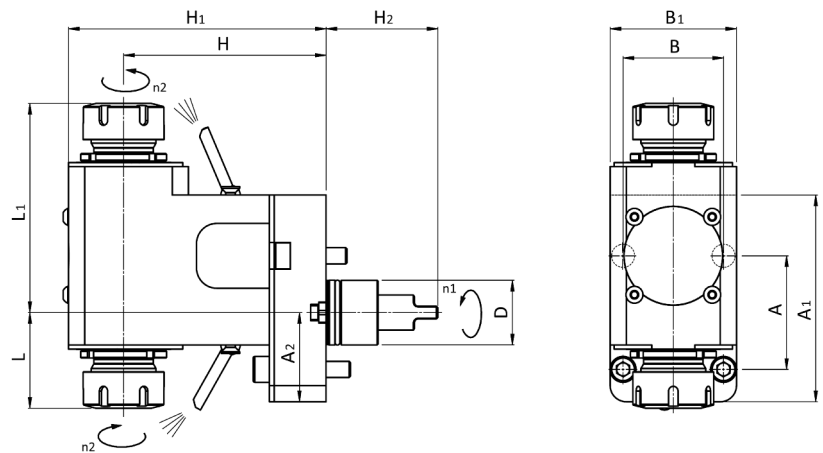





13/NZ		Codice code - code - Bestell Nr.	D	ER	H	H1	H2	L (min-max)	L1	L2	A	B	A1	B1	A2	B2	M <sub>2</sub> Nm	n <sub>2</sub> min-1	P kW
90°	 DIN 6499	 ±1 (1:1)	RRPPT 25 121UNZ	40	25	85	119	69	85,3-89			70	62	110	78		50	12000	7,5
			RRPPT 32 121UNZ	40	32	85	119	69	90,3-94			70	62	110	78			50	12000

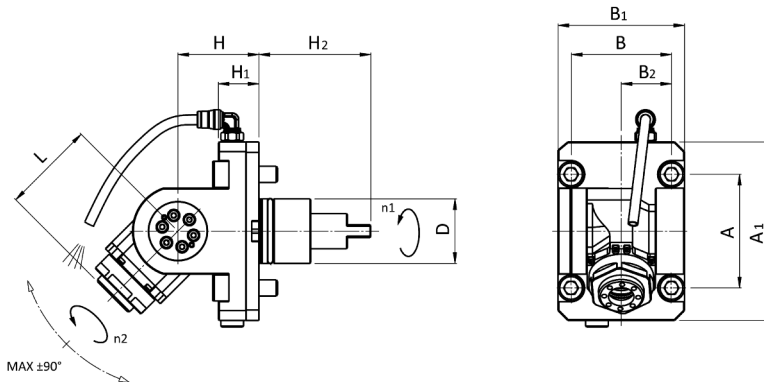
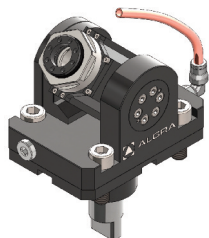





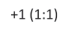

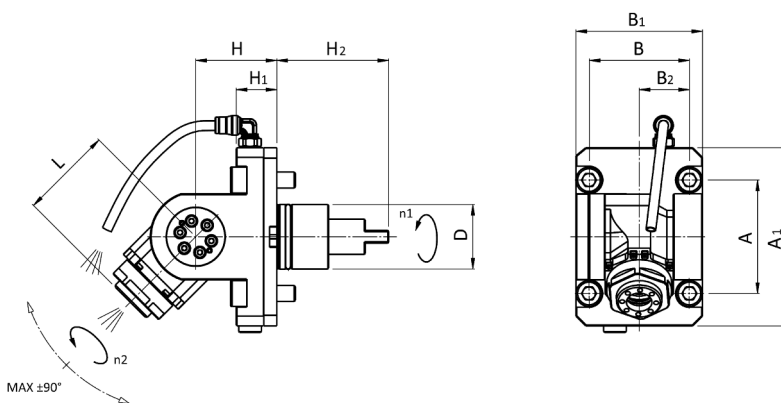
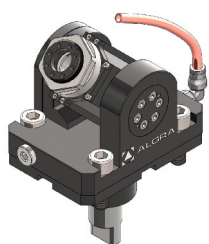

14/NZ		Codice code - code - Bestell Nr.	D	ER	H	H1	H2	L (min-max)	L1 (min-max)	A	B	A1	B1	A2	B2	M <sub>2</sub> Nm	n <sub>2</sub> min-1	P kW
90°	 DIN 6499	 ±1 (1:1)	RRPPTA25 421UNZ	40	25	125	69	159	50,4-54,1	120,4-124,1	70	62	127,5	78	55	50	12000	7,5
			RRPPTA32 421UNZ	40	32	125	69	159	55,3-59	125,3-129	70	62	127,5	78	55	50	12000	7,5





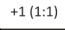

15/NZ			Codice	D	ER	H	H1	H2	L	L1	L2	A	B	A1	B1	A2	B2	M <sub>2</sub>	n <sub>2</sub>	P
			code - code - Bestell Nr.						(min-max)									Nm	min-1	kW
±90°			ROPPS 20 121UNZ	40	20	50	25	69	53,4-57,1			70	62	110	78			17	12000	5,5
 DIN 6499  +1 (1:1)																				
 EXTERNAL																				



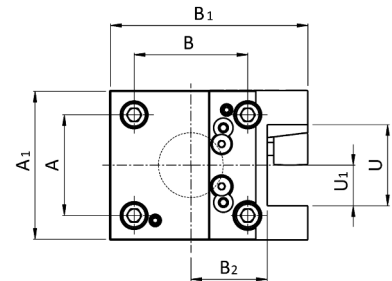
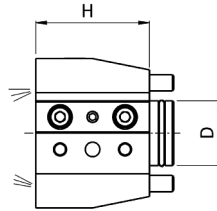

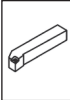
16/NZ			Codice	D	ER	H	H1	H2	L	L1	L2	A	B	A1	B1	A2	B2	M <sub>2</sub>	n <sub>2</sub>	P
			code - code - Bestell Nr.						(min-max)									Nm	min-1	kW
±90°			ROPPS 20 131UNZ	40	20	50	25	69	53,4-57,1			70	62	110	78			17	12000	5,5
 DIN 6499  +1 (1:1)																				
 INT./EXT.  100 bar  Filtration 30µm																				



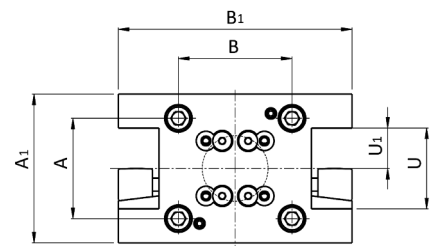
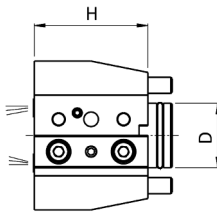

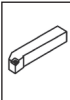
101/NZ		Codice code - code - Bestell Nr.	DMG MORI Part. No.	D	U	U1	U2	H	H1	H2	H3	A	B	A1	B1	A2	B2	B3
  EXTERNAL	E10/US 20 NZX70	T00224	40	40	20	70						62	70	78	115		50	
	E10/US 25 NZX70	T00267	40	50	25	70						62	70	92	122		50	
	E10/US 0.75" NZX70	T00234	40	1.5"	0.75"	70						62	70	78	115		50	
	E10/US 20 NZX95	T00225	40	40	20	95						62	70	78	115		50	
	E10/US 25 NZX95		40	50	25	95						62	70	92	122		50	
	E10/US 0.75" NZX95	T00235	40	1.5"	0.75"	95						62	70	78	115		50	
	E10/US 1" NZX70	T00272	40	2"	1"	70						62	70	92	122		50	



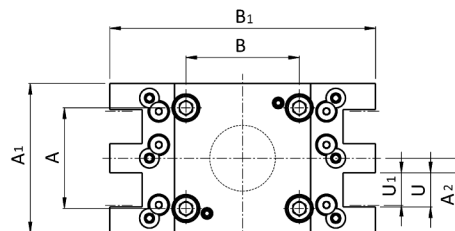
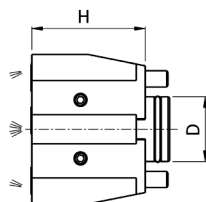
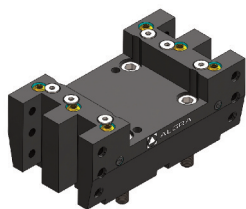

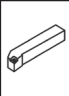
102/NZ		Codice code - code - Bestell Nr.	DMG MORI Part. No.	D	U	U1	U2	H	H1	H2	H3	A	B	A1	B1	A2	B2	B3
  EXTERNAL	E10/UD 20 NZX70	T00228	40	40	20	70						62	70	78	130			
	E10/UD 25 NZX70		40	50	25	70						62	70	92	144			
	E10/UD 0.75" NZX70	T00250	40	1.5"	0.75"	70						62	70	78	130			
	E10/UD 20 NZX95	T00226	40	40	20	95						62	70	78	130			
	E10/UD 25 NZX95		40	50	25	95						62	70	92	144			
	E10/UD 0.75" NZX95	T00249	40	1.5"	0.75"	95						62	70	78	130			



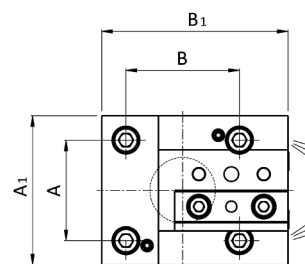
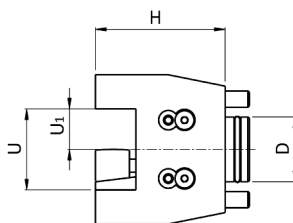
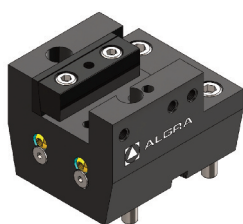

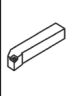
103/NZ		Codice code - code - Bestell Nr.	DMG MORI Part. No.	D	U	U1	U2	H	H1	H2	H3	A	B	A1	B1	A2	B2	B3
	 EXTERNAL	E10/UA 20 NZX70		40	21	20		70				62	70	92	164	9		



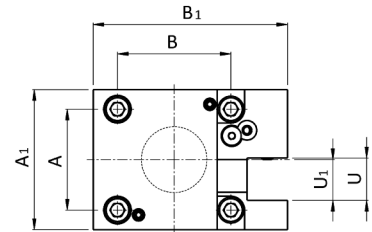
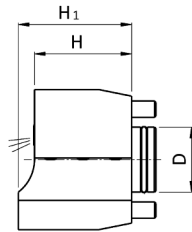

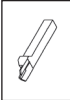
104/NZ		Codice code - code - Bestell Nr.	DMG MORI Part. No.	D	U	U1	U2	H	H1	H2	H3	A	B	A1	B1	A2	B2	B3
	 EXTERNAL	E10/UA 20 NZX80	T03017	40	40	20		80				62	70	78	115			
		E10/UA 25 NZX80	T03024	40	50	25		80				62	70	92	115			
		E10/UA 0.75" NZX80	T03018	40	1.5"	0.75"		80				62	70	78	115			
		E10/UA 1" NZX80	T03025	40	2"	1"		80				62	70	92	115			



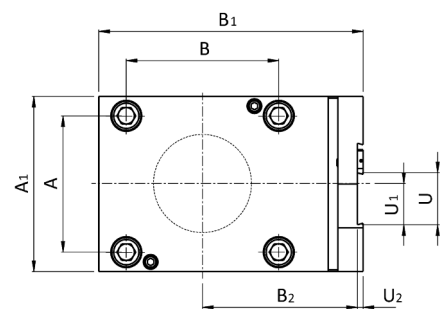
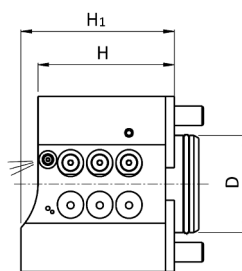

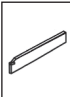
105/NZ		Codice code - code - Bestell Nr.	DMG MORI Part. No.	D	U	U1	U2	H	H1	H2	H3	A	B	A1	B1	A2	B2	B3
 		E10/UT 20 NZX85	T00251	40	21	20		75	85			62	70	78	115			
		E10/UT 25 NZX70		40	26	25		60	70			62	70	86	120			
		E10/UT 25 NZX85	T00268	40	26	25		75	85			62	70	86	120			
		E10/UT 0.75" NZX85	T00252	40	21	0.75"		75	85			62	70	78	115			
		E10/UT 1" NZX85	T00359	40	26	1"		75	85			62	70	86	120			



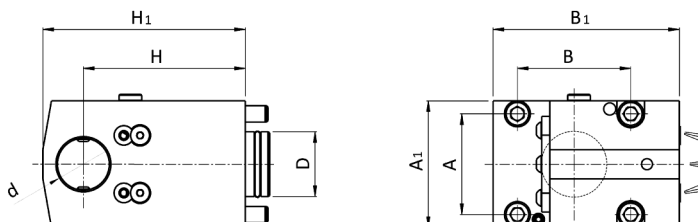

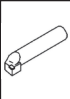
106/NZ		Codice code - code - Bestell Nr.	DMG MORI Part. No.	D	U	U1	U2	H	H1	H2	H3	A	B	A1	B1	A2	B2	B3
 		E10/TT 32 NZX70		40	32	25	2,36	60	70			62	70	80	137		81,5	

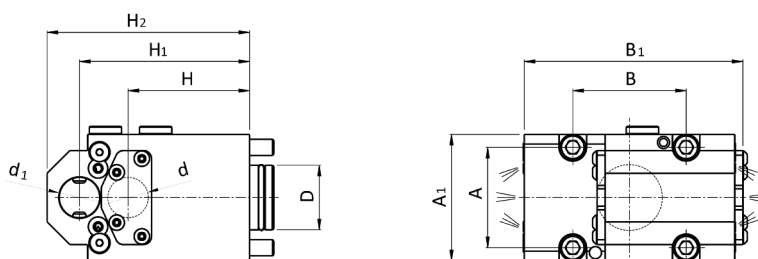

107/NZ		Codice code - code - Bestell Nr.	DMG MORI Part. No.	D	d	d1	d2	H	H1	H2	H3	A	B	A1	B1	A2	B2	B3
  INT./EXT.	<b>E10/BS 32 NZX100</b>	T10115 - T13132		40	∅ 32			100	125			62	70	78	115			
	<b>E10/BS 1.25" NZX100</b>	T10119 - T13135		40	∅ 1.25"			100	125			62	70	78	115			
	<b>E10/BS 32 NZX145</b>	T10260		40	∅ 32			145	175			62	70	78	115			
	<b>E10/BS 1.25" NZX145</b>	T10261		40	∅ 1.25"			145	175			62	70	78	115			

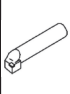

108/NZ		Codice code - code - Bestell Nr.	DMG MORI Part. No.	D	d	d1	d2	H	H1	H2	H3	A	B	A1	B1	A2	B2	B3
  INT./EXT.	<b>E10/BD 25 NZX75/105</b>	T10117		40	∅ 25	∅ 25		75	105	125		62	70	78	130			
	<b>E10/BD 1" NZX75/105</b>	T10139		40	∅ 1"	∅ 1"		75	105	125		62	70	78	130			







**La produzione:  
il lavoro**Production:  
work

La produzione viene sviluppata nella moderna struttura a temperatura controllata di Almenno San Salvatore, mentre negli stabilimenti di Brembilla (I-Bergamo) vengono effettuate le lavorazioni di montaggio ed assemblaggio di gruppi completi. La superficie coperta delle strutture è di mq. 15.000, dei quali mq. 1.000 sono adibiti agli uffici amministrativi, commerciali e tecnici. L'attività produttiva si svolge con l'utilizzo di impianti e macchinari CNC costantemente aggiornati alle nuove tecnologie ed in grado di sviluppare le seguenti lavorazioni:

- Asportazione di truciolo
- Elettroerosione
- Tornitura orizzontale e verticale
- Fresatura universale 5 assi
- Fresatura/tornitura
- Lappatura per fori e piani
- Rettifica in tondo interno ed esterno
- Rettifica in tangenziale oltre al montaggio di gruppi e sottogruppi completi.

*The production is developed in the modern, temperature controlled facility in Almenno San Salvatore, with Brembilla factories there are the assembly operations and the assembly of complete groups. The facilities covered area is of 15,000 sqm., 1,000 sqm. of which are used for the administrative commercial and technical offices. The production cycle takes place with the use of CNC fixtures and equipment constantly updated with new technologies and able to develop the following machining:*

- Chip machining
- Electroerosion
- Horizontal and vertical turning
- 5-axis universal milling
- Milling/turning
- Lapping for holes and plane surfaces
- Cylindrical internal and external grinding
- Tangential grinding in addition to the assembly of complete groups and subassemblies.

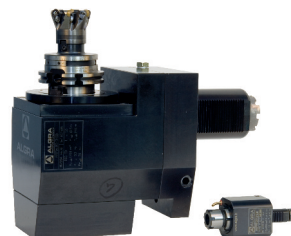
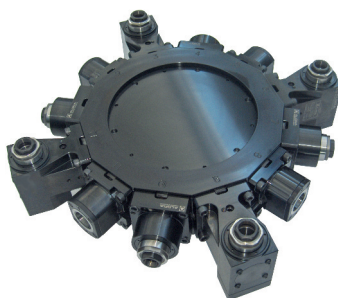
**Certificazioni:  
uno standard  
qualitativo**  
Certification:  
a quality  
standard

La tecnologia avanzata svolge un ruolo chiave nell'obiettivo di incrementare il proprio valore, quello dei propri prodotti, dei servizi e della capacità del personale, operando nel rispetto delle norme UNI EN ISO 9001:2008 e ISO 14001:2004. L'alto livello di sensibilità verso il rispetto delle regole di sicurezza e dell'ambiente è presente ed immediatamente percepito in tutte le strutture aziendali.

*Advanced technology plays a key role aiming to increase its value and the products, services and staff capacity value, operating in compliance with UNI EN ISO 9001:2008 and ISO 14001:2004. The high level of sensitivity towards the observance of safety rules and the environment is present and perceived immediately in all facilities.*



UNI EN ISO 9001:2008 - Cert. n° 0141

UNI EN ISO 14001:2004 - Cert. n° 0270A



ALGRA S.p.A. Divisione accessori  
Via Manzoni, 41 24031 Almenno S. Salvatore (BG)  
Tel. +39 035.64.20.51 • Fax +39 035.64.01.28  
algra.accessori@algra.it - www.algra.it